

**November 3, 2020 General Election In-person Voting Location Plan**

County: Trimble Total Pages in Plan: 1

\*\*\* Please fill out this page and the accompanying form (feel free to make copies if necessary). If you feel any attachments (maps, photos, etc.) will be useful in showcasing your plan, please attach those as well. \*\*\*

Is This an Amendment to an Existing Plan? **Y**(N)

If Yes, Please Explain Amendment: \_\_\_\_\_

**Narrative Explanation of County Plan:**

Election Day we plan on 2 sites, this is the same number of sites on any normal Election Day. One Bedford location will be located at Bedford Elementary School, 204 Mount Pleasant Road Bedford, KY 40006. We will have 16 Election Officers with 4 machines setup. The Milton location will be Milton Elementary School, 9245 Hwy 421 North, Milton, Ky 40045. We will have 12 Election Officers and 3 machines setup. Both locations will serve as County-wide Voting Centers. Our Voting equipment is Hart electronic Verity Scan and Verity Touchwriter. Each location will have one Verity Touchwriter.

RETURN ALL DOCUMENTS TO SBE BY FAX: 502-573-4369 or 502-696-1952 OR BY EMAIL: [KAREN.SELLERS@KY.GOV](mailto:KAREN.SELLERS@KY.GOV) BEFORE SEPTEMBER 30, 2020.

\* Office Use Only \*

Seen and Approved By: SBE \_\_\_\_\_ SOS \_\_\_\_\_ GOV \_\_\_\_\_

**November 3, 2020 General Election In-person Voting Location Plan**

County: Trimble Total Pages in Plan: \_\_\_\_\_

\*\*\* Please fill out this page and the accompanying form (feel free to make copies if necessary). If you feel any attachments (maps, photos, etc.) will be useful in showcasing your plan, please attach those as well. \*\*\*

Is This an Amendment to an Existing Plan? Y/N

If Yes, Please Explain Amendment: \_\_\_\_\_

**Narrative Explanation of County Plan:**

Bedford Location: Voters will enter the left set of front doors, stay to the left side of the hall. The voter will enter the left set of doors to the Cafeteria. After casting the ballot the voter will exit the right side Cafeteria doors, staying to the right side of the Hall and exiting the right front doors of the building. Orange cones will be used to divide the hall.

Milton Location: Voters will enter the right set of front doors, stay to the right and enter the Cafeteria through the right side door. After casting the ballot the voter will exit the opposite door and follow the opposite hall to exit the building through the left set of front doors

This was the same plan for the Primary which the Health Department and Emergency Management approved.

**RETURN ALL DOCUMENTS TO SBE BY FAX: 502-573-4369 or 502-696-1952 OR BY EMAIL: [KAREN.SELLERS@KY.GOV](mailto:KAREN.SELLERS@KY.GOV) BEFORE SEPTEMBER 30, 2020.**

**\* Office Use Only \***

Seen and Approved By: SBE \_\_\_\_\_ SOS \_\_\_\_\_ GOV \_\_\_\_\_

Facility Name/Type <small>*Please Note Which Facility Will Serve as County-wide Voting Center*</small>	Address	Type & Number of Voting Machines	Number of poll workers needed to staff
Bedford Elementary School	20A Mount Pleasant Rd Bedford, Ky 40006	4 Hart Intercivic Verity Scan	16
Milton Elementary School	9245 Hwy 421 N Milton, Ky 40045	1 Hart Intercivic Verity Touch Writer	
		3 Hart Intercivic Verity Scan	12
		1 Hart Intercivic Verity Touch Writer	



**Bedford Elementary School**

**Address:** 204 Mount Pleasant Rd, Bedford, KY 40006

**Phone:** (502) 255-3217

Type your notes here.



Data from: GreatSchools · Zillow · SchoolDigger · Freebase · Facebook

© 2020 TomTom © 2020 HERE

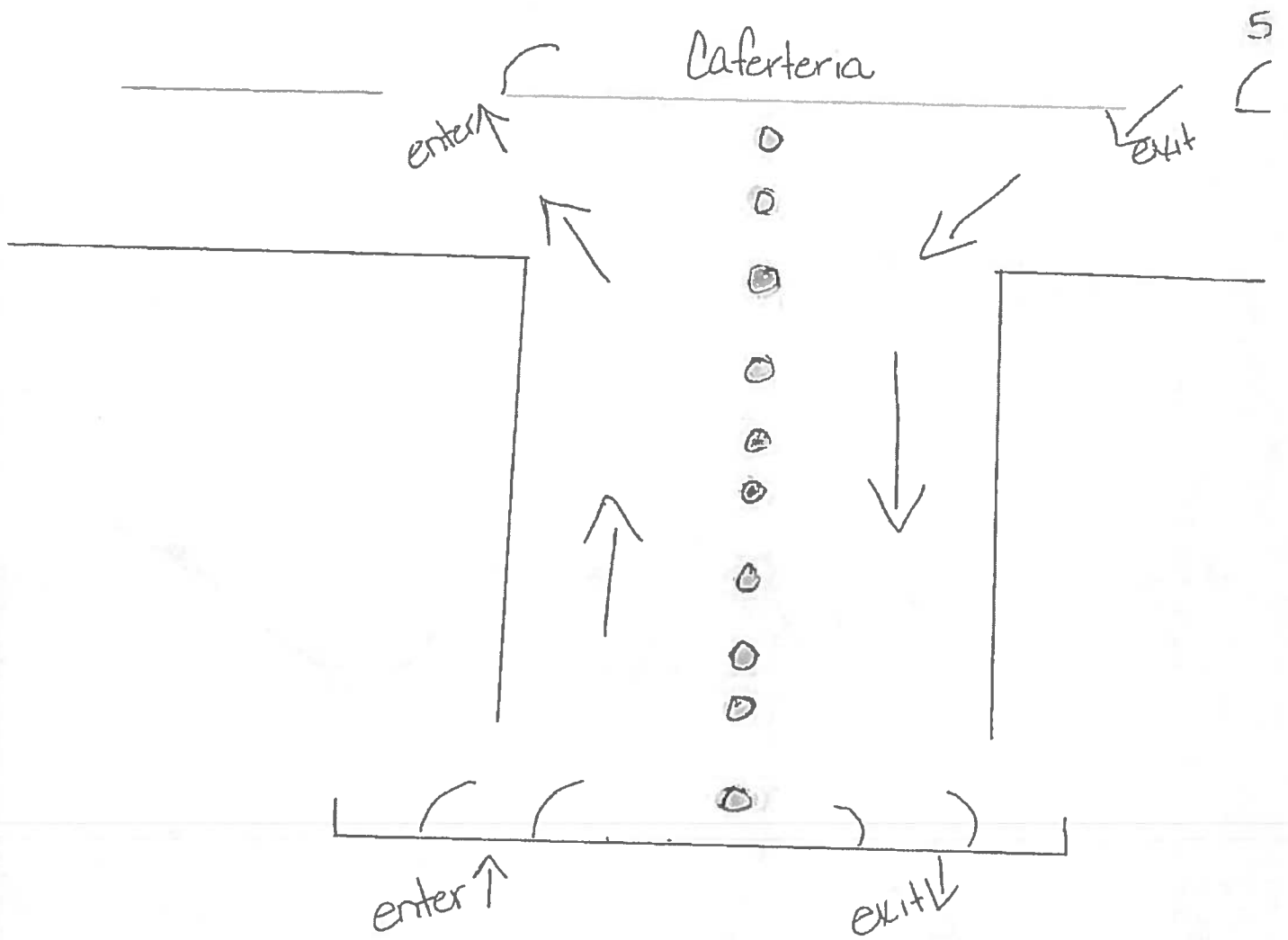

Bedford

● Orange Cone



**Milton Elementary School**

**Address:** 9245 Highway 421 N, Milton KY 40045

**Phone:** (502) 268 3322

Type your notes here.



Data from: GreatSchools · Zillow · SchoolDigger · Freebase

© 2020 TomTom © 2020 HERE

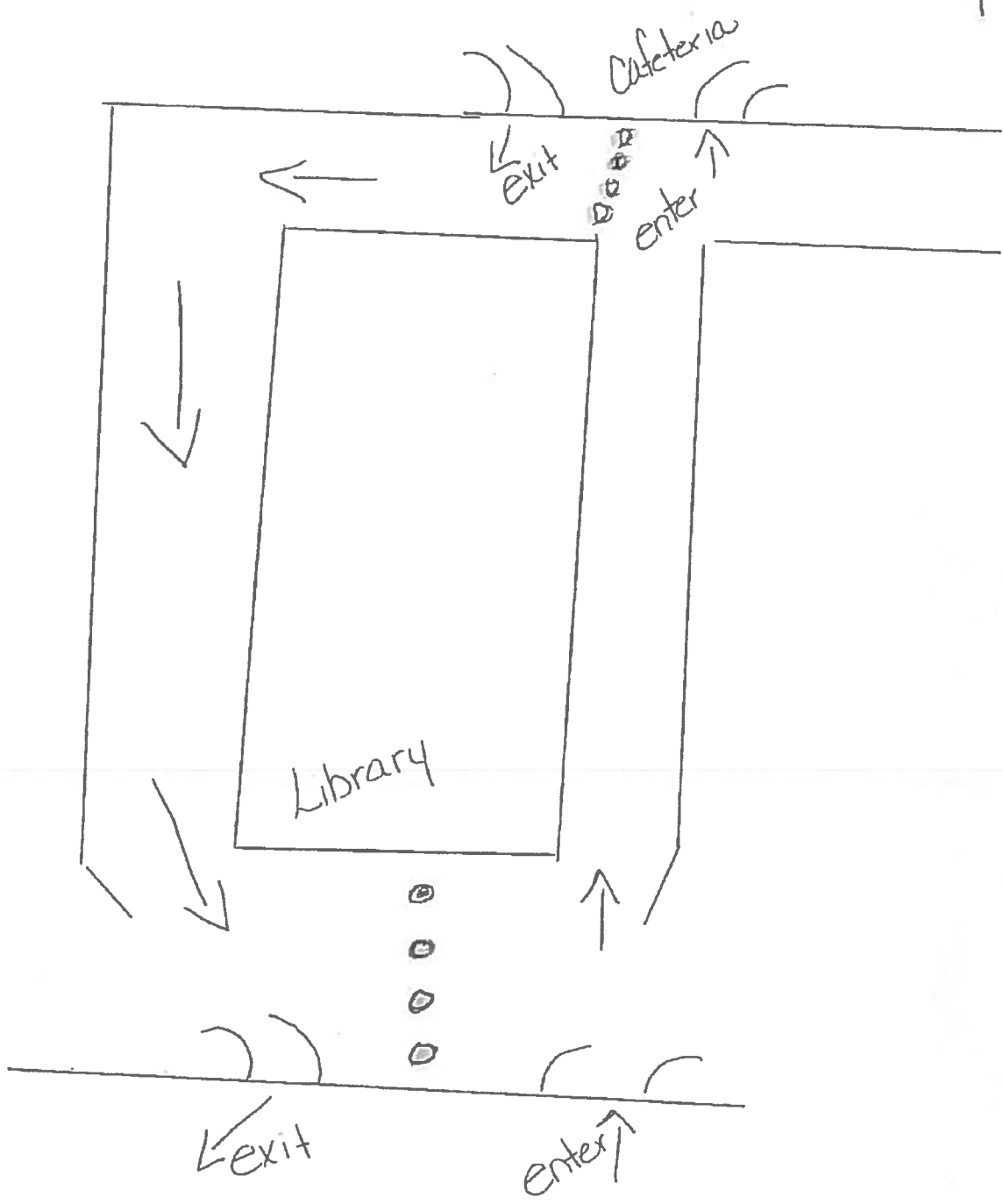

Milton

### 2020 General Election Early Voting Locations

\*\* These locations do not need to be approved, though the emergency regulation states that SBE and SOS will help counties publicize early voting locations. Completing this form makes that possible.

Name of Location	Address of Location	Dates/Times Available
Trimble County Courthouse,	3D Hwy 42 East, Bedford, KY 40006	September 28 - November 2 Monday, Tuesday Thursday, Friday 8:30 - 4:30 Wednesday 8:30 - Noon Open - Saturdays Oct 10, 17, 24 + 31 8:00 - Noon
		Open Monday Oct 19 + 26 8:30 - 8:00pm